



Client: Nottingham Trent University

## Heart of the Campus - Clifton

**Client**  
NTU

**Construction Cost**  
£5million

**Key dates**  
Up to RIBA Stage C completed

**Project Design Team**  
JMF Chartered Architects

**Procurement Route**  
Traditional

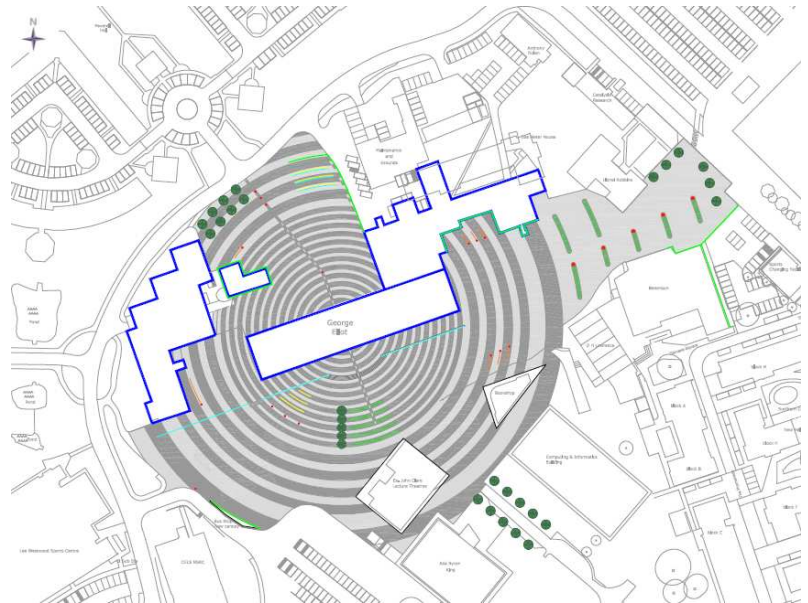

A proposed landscape masterplan in conjunction with the new Heart of the Campus redevelopment at the NTU Clifton Campus.

JMF and NTU worked together to generate a design brief; JMF then produced a number of options based on site constraints and budget.

The preferred option is based on a 'Ripple' effect, where the heart generates the point of centrality, with radiating rings of porous paving, areas of green space, trees and associated bike racks, lighting and seating all radiate from the fulcrum.

The proposal addresses the various pedestrian axis, culminating in a generous plaza, providing a meeting point within the heart of the campus.

*For more information please contact James Firth on 07790 019248.*

